

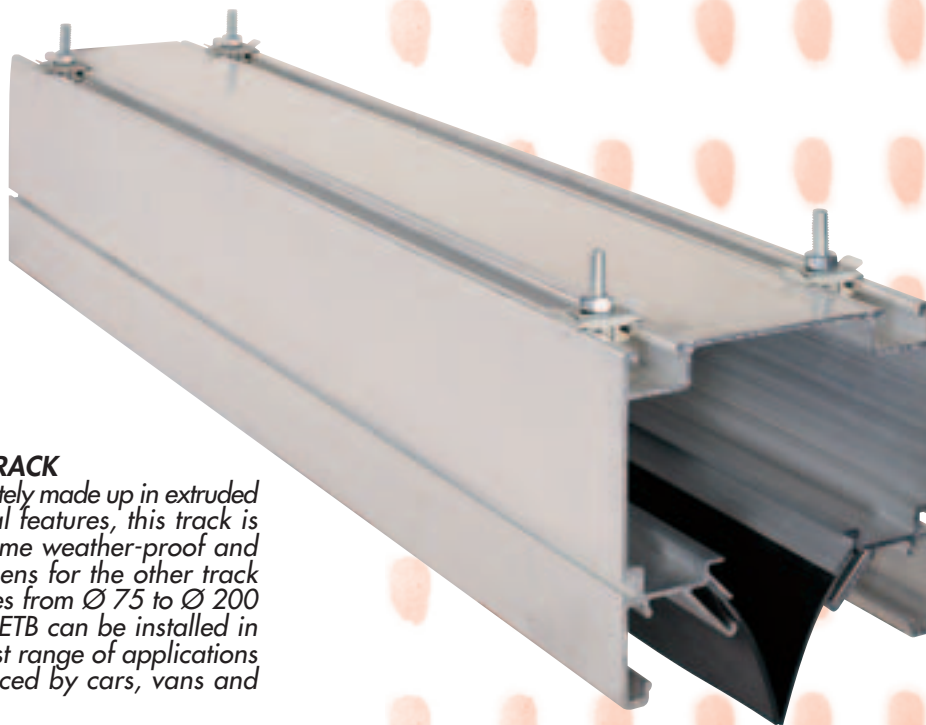

EXTRUDED ALUMINIUM TRACK



**ET****GB EXTRUDED ALUMINIUM TRACK**

Modular aerial track completely made up in extruded aluminium. Thanks to its structural features, this track is light-weighted and at the same time weather-proof and with a sturdy contour. As it happens for the other track models, several carriages for hoses from Ø 75 to Ø 200 and the reels model AEML and AETB can be installed in this system so as to offer the widest range of applications for the extraction of gases produced by cars, vans and lorries.

ETB

- GB Extruded aluminium track - equivalent Ø 150 mm
Max flow rate 1.400 m³/h

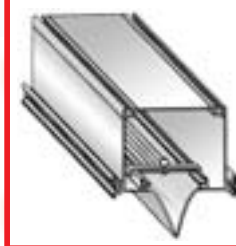
**ETM**

- GB Extruded aluminium track - equivalent Ø 180 mm
Max flow rate 1.800 m³/h

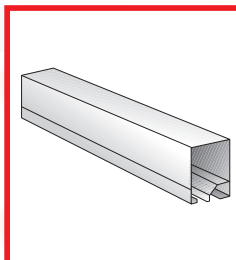
**ETL**

- GB Extruded aluminium track - equivalent Ø 210 mm
Max flow rate 2.750 m³/h

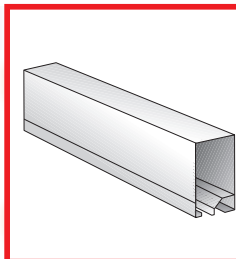
**FITTINGS**

- GB Support/jointing bracket - Jointing band - Strengthened support/jointing bracket - Closing flange with support - Outlet flange with support

SLIDING CARRIAGES SYSTEM FOR TRACK ET



SLIDING CARRIAGES SYSTEM

The sliding carriages can have several uses according to the fittings they are equipped with.





FITTING FOR SLIDING CARRIAGES SYSTEM

Serie CAT - ETB

 *Sliding carriage for hoses*

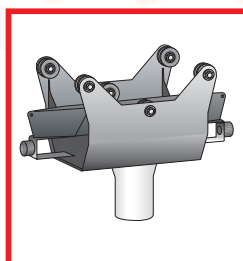

Serie CAT - EML

 *Sliding carriage for hoses*

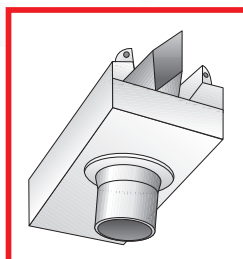

Serie BIL

 *Universal equalizer with counter-release suitable*

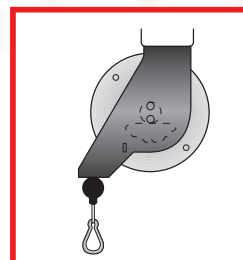

Serie AN

 *Coupling for hose suspension on CAT carriage*

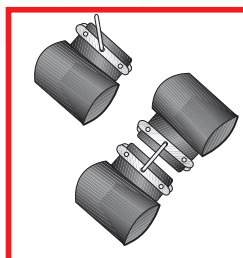

SLINDING REELS FOR ALUMINIUM TRACK ET



GB SLIDING REELS FOR ALUMINIUM TRACK ET

The sliding hose reels meet with outstanding success thanks to their several possibilities of use. They can in fact slide all along the track both manually and electrically-driven.



Serie AETB - C

GB Mechanical rewinding reel equipped with flexible hose T-GAS, safety stop ATS, nozzle BNT, hose-clamps and hose-clamps covers **FOR TRACKS MODEL ETB**



Serie AEML - C

GB Mechanical rewinding reel equipped with flexible hose T-GAS, safety stop ATS, nozzle BNT, hose-clamps and hose-clamps covers **FOR TRACKS MODEL ETM - ETL**

Serie AML

GB Mechanical rewinding reel equipped WITHOUT flexible hose **FOR TRACKS MODEL ETM - ETL**



SLINDING REELS FOR ALUMINIUM TRACK ET

Serie ATML

GB Power-driven hose reel with remote control, without flexible hose **FOR TRACKS MODEL ETM - ETL**

Serie APML

GB Power-driven hose reel with push-button control, without flexible hose **FOR TRACKS MODEL ETM - ETL**

Serie ATML - TR

GB Power-driven carriage-mounted rewinding and translating reel with remote control without flexible hose **FOR TRACKS MODEL ETM - ETL**

Serie APML - TR

GB Power-driven carriage-mounted rewinding and translating reel, without flexible hose **FOR TRACKS MODEL ETM - ETL**

Serie LAF

GB Feeding line for supplying electricity to ATML and APML power-driven reels

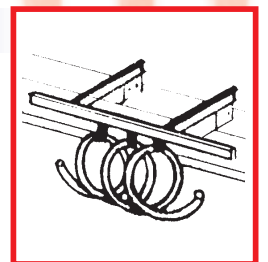

Attention: all the power-driven reels are equipped with upwards / downwards electric adjustment safety stops. In order to supply electricity to the power-driven reels it necessary feeding line mod. LMF

BRACKETS & HANGER FOR TRACK



Serie SFSZ

GB Ceiling hanger for inclination

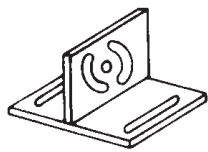

Serie SFPZ

GB Fixed wall-fastening hanger

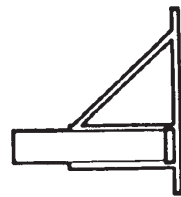

Serie SFPR

GB Adjustable wall-fastening hanger

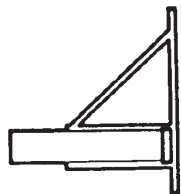

Serie SSI

GB Inclinal ceiling hanger

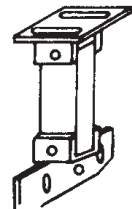

Kit tiranti

GB 10 mt. long steel cable sect. 5 mm + 8 holdfast and 2 tie-rods

